

SYMBOL LEGEND

- # WALL UTP LOCATION, QTY AS NOTED
- ⊗ CEILING UTP LOCATION, QTY AS NOTED
- ☐ TELECOM CABINET
- TELECOM BUS-BAR
- ☐ REPLACE CABINET

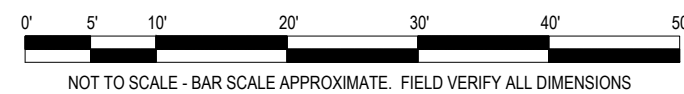

UPPER NATATORIUM
602

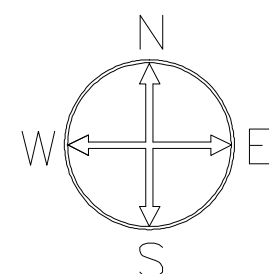

1
T101F
UPPER NATATORIUM
NTS

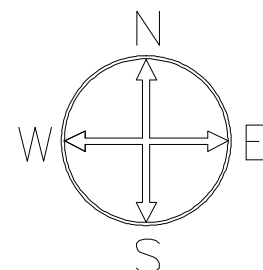
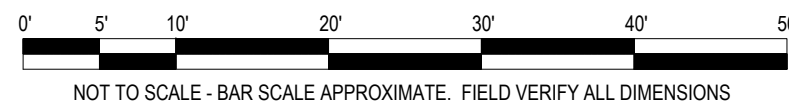
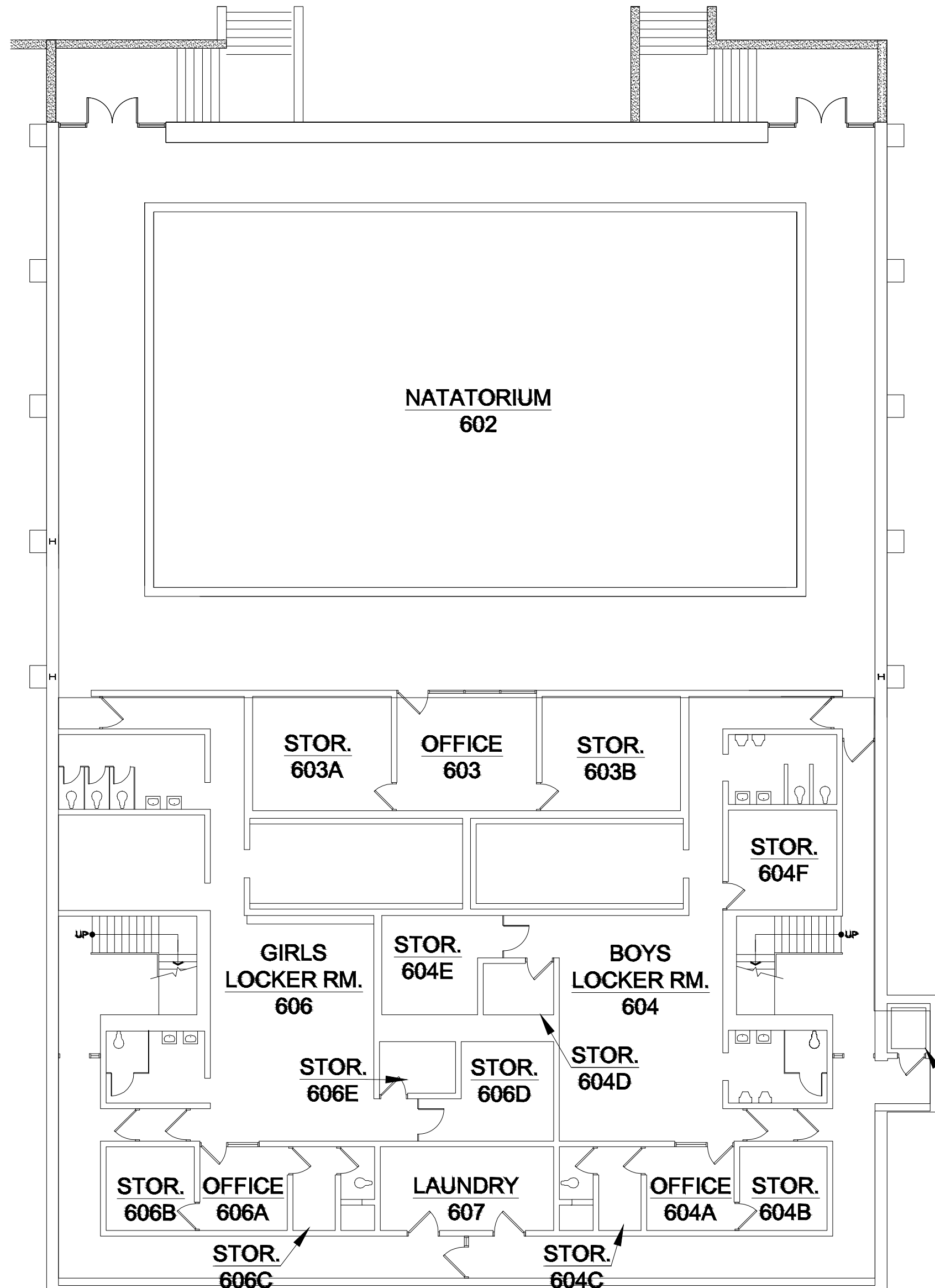

2
T101F
1ST FLOOR NATATORIUM
NTS

GENERAL NOTES

- ALL UTP CABLE SHALL BE ANSI/TIA CATEGORY 6A. PLACE WALL LOCATIONS IN A SURFACE MOUNTED SINGLE-GANG BACK BOX WITH A WHITE TWO PORT FACEPLATE.
- THE UNUSED TOP PORT OF THE FACEPLATE IS TO BE FILLED WITH A BLANK KEYSTONE JACK INSERT.
- PLACE WALL LOCATIONS CENTERED BELOW WHITEBOARD AT STANDARD HEIGHT.
- LOCATIONS WITHOUT WHITEBOARDS, CENTER THE INSTALLATION ON THE WALL AT STANDARD HEIGHT.
- ALL CABLE BELOW CEILING SHALL BE CONCEALED IN RACEWAY PROVIDED BY CONTRACTOR.
- PROVIDE CEILING LOCATION WITH SERVICE LOOP LONG ENOUGH TO REACH THE FARTHEST LOCATION IN THE ASSOCIATED ROOM. SECURELY FASTEN SERVICE LOOP TO STRUCTURE.
- TERMINATE ALL CATEGORY 6A CABLES ON WHITE 8P/8C (RJ45) JACKS.
- LOCATION OF BUS BLOCKS ARE ESTIMATED, USE BEST PRACTICES FOR INSTALLATION LOCATION.
- FOR ESTIMATES ASSUME ALL CABINETS NEED GROUNDING.

KEYMAP

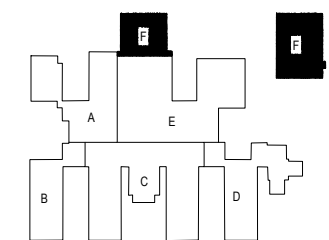

SWARTZ CREEK
COMMUNITY SCHOOLS

STRUCTURED CABLING

SWARTZ CREEK
MIDDLE SCHOOL



CONVERGENT
TECHNOLOGY PARTNERS

6197 Miller Road Suite 4
Swartz Creek, MI 48473
Phone: 810.720.3820
www.ctpartners.net

TECHNOLOGY DESIGN | CONSULTING | PLANNING

MS-T101F