

SAMPLE STORE

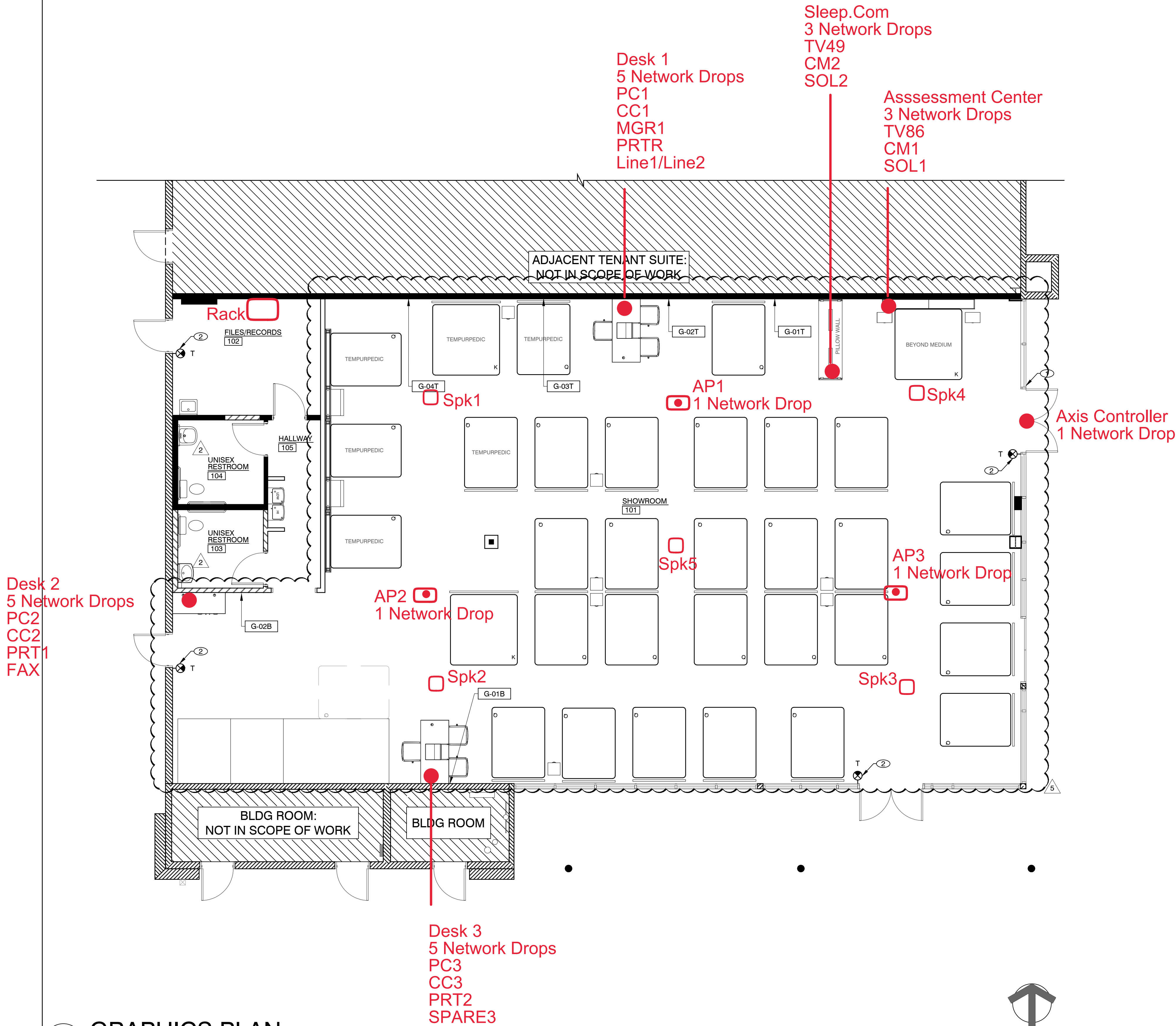

GENERAL GRAPHIC PLAN NOTES

- ALL GRAPHICS TO BE TENANT PROVIDED, GC INSTALLED. COORDINATED IN-FIELD WITH TENANT. REFERENCE TENANT'S GRAPHIC MANUAL FOR ADDITIONAL INFORMATION AND INSTALLATION INSTRUCTIONS.
- ALL MATTRESS BRAND LOCATIONS TO BE COORDINATE IN-FIELD WITH TENANT.
- PROVIDE AND INSTALL OCCUPANCY LOAD SIGN IN CONSPICUOUS LOCATIONS NEAR MAIN EXITS AT 6'-10" AFF PER CBC SECTION 1004.9.

KEYNOTES

- PROVIDE NEW ISA SIGNAGE AS REQUIRED ON STOREFRONT WHERE INDICATED ON PLAN. REFERENCE 16/A8.0 FOR ADDITIONAL INFORMATION.
- PROVIDE NEW TACTILE EXIT SIGN AS REQUIRED AT EXIT WHERE INDICATED ON PLAN. REFERENCE 15/A8.0 FOR ADDITIONAL INFORMATION.

LEGEND

T TACTILE EXIT SIGN

AREA CALCULATIONS

ROOM NO.	ROOM NAME	AREA NAME	AREA - (SF)
101	SHOWROOM	SERVICE	± 3,295
102	FILES/RECORDS		± 153
103	WOMEN'S RESTROOM		± 60
104	MEN'S RESTROOM		± 65
105	HALLWAY		± 80
TOTAL:			3,810

MATTRESS COUNT: 33 TOTAL

PROJECT COORDINATOR/ DESIGN CONSULTANT



IN ASSOCIATION WITH THE ARCHITECT

R. H. SWEERS II,  
PROPRIETOR

RH SWEERS ARCHITECT  
EMAIL: rhs@sweersarch.com

THIS DRAWING PREPARED UNDER MY SUPERVISION, AND I DISCLAIM RESPONSIBILITY FOR THE EXISTING BUILDING, CONSTRUCTION ELEMENTS, SITE CONDITIONS, OR ANY DOCUMENTS WHICH DO NOT BEAR MY SIGNATURE AND SEAL.

SEAL

DATE SIGNED:

PROJECT NO.: 343-1106  
DRAWN BY: VA  
CHECKED BY: BW

MATTRESS FIRM

SANTA FE TRAIL PLAZA  
10761 VALLEY BLVD.  
EL MONTE, CA 91731

NO.	REVISIONS:	DATE:
2	REVISION #2: CITY COMMENTS	01.06.22
5	SPACE PLAN REVISIONS	09.27.22

LANDLORD REVIEW ISSUE DATE: 10/05/2021  
TENANT REVIEW ISSUE DATE: 10/05/2021  
BID ISSUE DATE: 10/05/2021  
PERMIT ISSUE DATE: 10/05/2021

DRAWING TITLE:  
GRAPHICS PLAN AND  
LEGENDS

DRAWING NUMBER:

A2.6

© 2021 idGROUP, LLC