

Change Order Bulletin

COB-26r

City and County of Denver | Department of Public Works Denver Central Library Renovations Interior Renovation Package

DATE January 17, 2023

PROJECT DPL | Central Library Renovations
GoBond2018-043

TO Adam Tromohlen
Project Manager GH Phipps
5995 Greenwood Village Blvd
Suite 100
Greenwood Village, CO 80111

This bulletin is issued to define the scope of revision in drawings and/or specifications for a contemplated change order. The work called for by these revisions shall be in accordance with the requirements of the original contract documents.

Please prepare and submit a proposal for the changes described below. This proposal shall include a statement as to the effect this change will have on the time for completion of the project.

This bulletin is NOT an authorization to proceed.

DESCRIPTION

1. Provide temporary data (as shown on the following page) from two temporary switches located in B1 through the Level 1 floor into the Services Area in Pavilion, Pre-Function, LPS, and Temporary Western History areas.
 - a. Each Blue Dot on the attached plan represents a 1" dia hole drilled through the slab
 - b. Each 1" hole can accommodate up to four Cat6A cables
 - c. Provide the number of cables shown on the attached plan

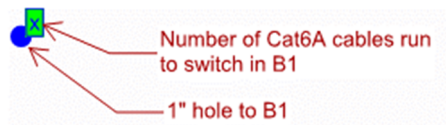

- d. J-hooks and Velcro ties may be used at B1 ceiling to support cabling
- e. All Cat6A cables are to be terminated at the switch end (in B1) and landed
- f. Provide 6 feet of excess cable at each dropped location, unless noted otherwise
- g. Terminate cables with RJ45 and coil cable on the floor at each drop location

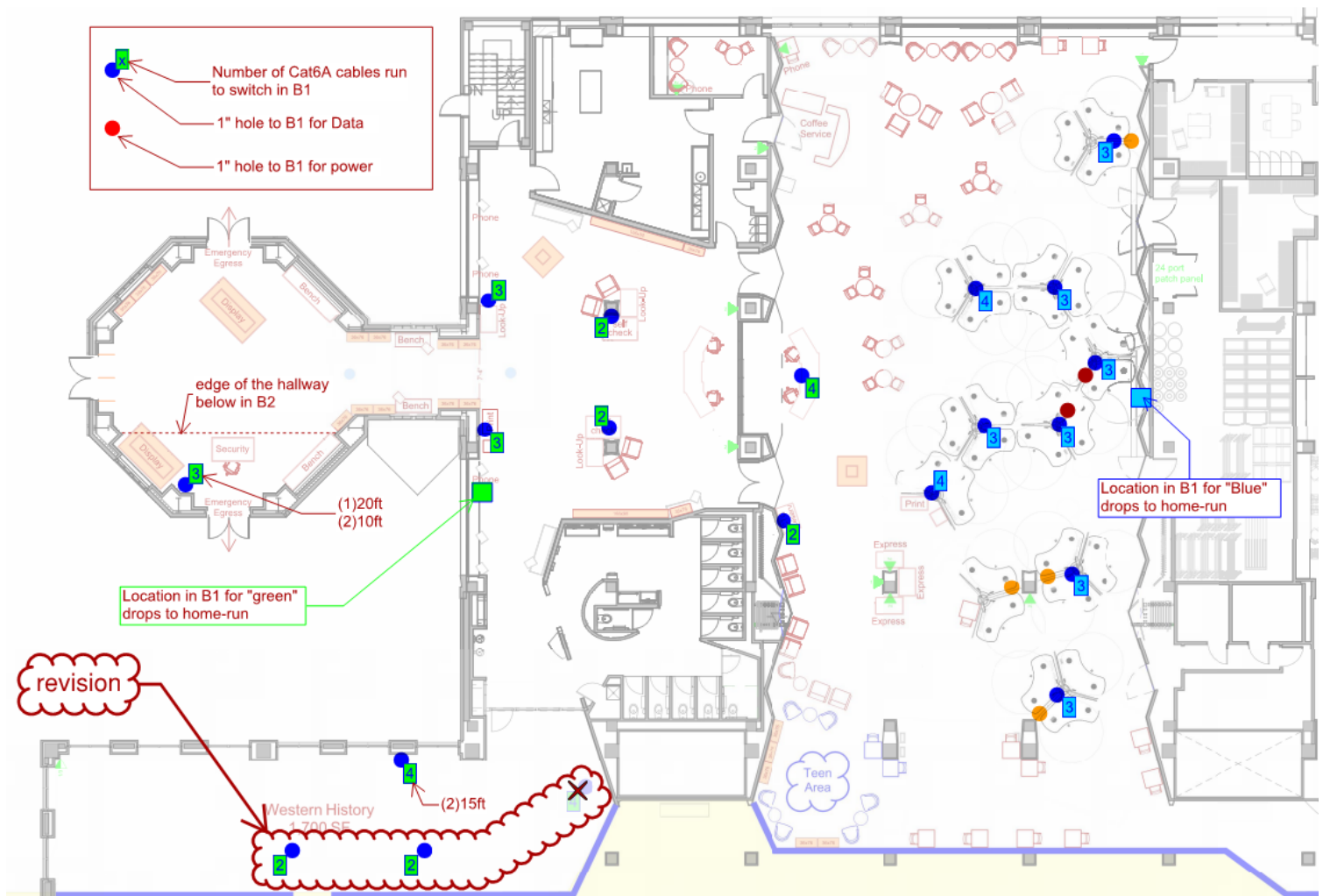

2. Pull multi-mode Fiber Optic Cable from the B1 Telecom Room to the two remote switch locations in B1
3. Connect power to tri-plex computer desks. Maximum 8 computer stations per circuit. Pull power from spare circuits in nearest electrical panel in B1 to two locations marked on plan above with red dot.
 - a. Maximum 10 Desktop Computers per 15 amp circuit.
4. Provide grounded plugs to the ends of the whips at four tri-plex tables marked by orange dots.

ISSUED BY **Anne Pharamond**
Architect | Sr. Project Manager
studiotrope Design Collective
apha@studiotrope.com

END COB-26r