

1

BBS21009

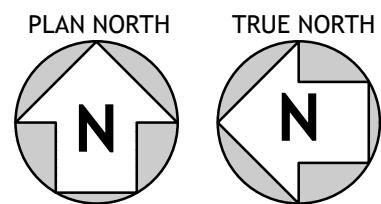

ELECTRICAL SYMBOL LEGEND	
SYMBOL	DESCRIPTION
	2 X 4 LED FIXTURE
	2 X 4 LED FIXTURE WITH BATTERY BACKUP
	1 X 4 LED FIXTURE
	1 X 4 LED FIXTURE WITH BATTERY BACKUP
	4' LED STRIP FIXTURE
	4' LED STRIP FIXTURE WITH BATTERY BACKUP
	SURFACE MOUNTED TRACK AND TRACK HEAD
	PENDANT MOUNTED LIGHT FIXTURE
	RECESSED DOWNLIGHT FIXTURE
	RECESSED WALLWASH LIGHT FIXTURE
	WALL MOUNTED LIGHT FIXTURE
	HOOD LIGHT
	CEILING MOUNTED EXIT SIGN, SHADE INDICATES FACE
	WALL/CEILING MOUNTED EMERGENCY BUGEYE FIXTURE
	COMBINATION EXIT SIGN/EMERGENCY BUGEYE
	EMERGENCY REMOTE HEAD LIGHT FIXTURE
	JUNCTION BOX
	WALL MOUNTED DUPLEX RECEPTACLE
	FLOOR MOUNTED DUPLEX RECEPTACLE
	WALL MOUNTED SINGLE RECEPTACLE
	FLOOR MOUNTED SINGLE RECEPTACLE
	SPECIAL RECEPTACLE
	WALL MOUNTED QUADRUPLUX RECEPTACLE
	WALL MOUNTED DUPLEX RECEPTACLE WITH USB CHARGER
	SINGLE POLE SWITCH
	THREE POLE LIGHT SWITCH
	PILOT LIGHT SWITCH
	SINGLE THROW THERMAL SWITCH
	MOTOR RATED SWITCH
	MOTION SENSOR
	BUZZER
	BELL
	PUSHBUTTON (MOMENTARY)
	MOTOR
	TELEPHONE BACKBOARD
	TELEPHONE OUTLET
	FLOOR MOUNTED TELEPHONE OUTLET
	POS CONNECTION
	FLOOR MOUNTED POS CONNECTION
	COMBINATION DATA AND PHONE JACK
	FLOOR MOUNTED COMBINATION DATA AND PHONE JACK
	DISCONNECT SWITCH
	PAGER OUTLET
	SECURITY JUNCTION BOX
	TELEVISION JACK
	KEYED SWITCH
	PANELBOARD
	TRANSFORMER
	LOW VOLTAGE DOORBELL TRANSFORMER
	SWITCHED CIRCUITRY BURIED OR IN SLAB
	CIRCUITRY IN WALL OR CEILING
	HOMERUN BACK TO PANEL
	POINT OF CONNECTION
	ISOLATED GROUND
	WEATHERPROOF
	GROUND FAULT CIRCUIT INTERRUPTER
	MOTOR CONTROL TERMINAL
	PRIOR TO ROUGH-IN
	INTEGRATED FACILITY STRUCTURE (SWITCHGEAR)
	INTEGRATED POWER CENTER (SWITCHGEAR)
	FIRE ALARM CONTROL PANEL
	FIRE ALARM ANNUNCIATOR PANEL
	FIRE ALARM PULL STATION
	FIRE ALARM HORN/STROBE DEVICE
	FIRE ALARM STROBE DEVICE
	FIRE ALARM CEILING MOUNT HORN/STROBE DEVICE
	FIRE ALARM WATER FLOW HORN/STROBE DEVICE
	FIRE ALARM SMOKE DETECTOR
	FIRE ALARM HEAT DETECTOR
	FIRE ALARM DUCT SMOKE DETECTOR
	REMOTE TEST SWITCH
	TAMPER SWITCH
	FLOW SWITCH
NOTE: NOT ALL SYMBOLS MAY APPEAR ON DRAWINGS.	

KITCHEN EQUIPMENT SCHEDULE													
ITEM NO.	QTY	ITEM DESCRIPTION	EQUIPMENT REMARKS	AMPS	W/KW	HP	VOLTS	PH	DIRECT PLUG	NEMA	AFF HGT.	ELECTRICAL REMARKS	CIRCUIT
1	1	BLOCK ICE PRODUCTION MACHINE		12.5		.5	120	1	X		52" AFF	CONFIRM EXACT LOCATION W/G.C.	LA-1
1A	1	BLOCK ICE CONDENSING UNIT	REMOTE UNIT ON ROOF				460	3	X		REMOTE		LA-3/5/7
2	4	BLOCK ICE SHAVER			.2		115	1	X	5-15P	52" AFF		LB-2; LB-4; LB-17; LB-12
4	1	TROPICAL DRINK STATION 72" 30 CONTAINER			.06		120	1	X	5-15P	42" AFF		LB-41
6	1	SIMPLE SYRUP MIXER		6.6			115	1	X		80" AFF		LB-23
8	1	ICE MACHINE W/CONDENSING UNIT		20			115	1	X		48" AFF		LB-19
14	2	COMMERCIAL BAR BLENDER		13.0			115	1	X	5-20P		E.C. PROVIDE DUPLEX RECEPTACLE.	LB-40; LB-42
17	1	ICE CREAM FREEZER		20			120	1	X	5-20P	18" AFF		LB-16
19	1	CHEST FREEZER		20			120	1	X	5-20P		E.C. PROVIDE DUPLEX RECEPTACLE.	LB-44
25	1	BEVERAGE DISPENSER		1.9			120	1	X	5-20P	24" AFF	E.C. PROVIDE DUPLEX RECEPTACLE.	LB-49
26	2	CASH MANAGEMENT SYSTEM		4.0			120	1	X	5-20P	42" AFF	E.C. PROVIDE DUPLEX RECEPTACLE.	LB-34; LB-53
31	1	SOUND/SURVEILLANCE SYSTEM		6.0			115	1	X	5-15P	18" AFF	E.C. PROVIDE DUPLEX RECEPTACLE.	LB-43
43	3	BB LOGO BUILDING SIGN		6.2			120	1	X				LB-6; LB-24; LB-37
47	1	CUSTOM BAHAMA BUCKS OPEN SIGN		20			120	1	X				LB-15
54	1	STACKABLE WASHER/DRYER (WASHER)		20			120	1	X	5-20P	18" AFF	E.C. PROVIDE DUPLEX RECEPTACLE.	LB-27
54	1	STACKABLE WASHER/DRYER (DRYER)		20			208	1	X		18" AFF	E.C. PROVIDE SPECIAL RECEPTACLE.	LB-29/31
57	1	WALK-IN FREEZER EVAPORATOR		11		2	208	1	X		72" AFF	LIGHTS, HEATERS AND CONTROLS	LA-18
57A	1	WALK-IN FREEZER REMOTE CONDENSING UNIT		20			208	3	X		REMOTE	CONFIRM EXACT LOCATION W/G.C.	LA-2/4/6
60	1	BAG-N-BOX		6.2			120	1	X	5-20P	18" AFF		LB-25
65	1	HEADSET INTERCOM SYSTEM		9.0		2	120	1	X		72" AFF		LB-28
66	1	FLY FAN		2.0			120	1	X				LB-10
75	1	LEMONADE STATION		8.2			115	1	X	5-15R	52" AFF		LB-21

ALLOWED CONDUIT LOCATIONS	
CONDUIT INSTALLATION LOCATION	ALLOWABLE CONDUIT TYPE
BELOW GRADE OUTSIDE OF SLAB PERIMETER	RIGID STEEL CONDUIT OR NONMETALLIC CONDUIT (SCHEDULE 40 OR SCHEDULE 80 PVC)
BELOW GRADE GOING THRU GRADE BEAM	RIGID STEEL CONDUIT OR NONMETALLIC CONDUIT (SCHEDULE 40 OR SCHEDULE 80 PVC) WITH SLEEVE
IN OR UNDER SLAB ON GRADE	RIGID STEEL CONDUIT OR NONMETALLIC CONDUIT (SCHEDULE 40 OR SCHEDULE 80 PVC)
OUTDOOR LOCATIONS, ABOVE GRADE	RIGID STEEL CONDUIT
IN SLAB ABOVE GRADE	RIGID STEEL CONDUIT OR NONMETALLIC CONDUIT (SCHEDULE 40 OR SCHEDULE 80 PVC)
WET AND DAMP LOCATIONS	RIGID STEEL CONDUIT OR NONMETALLIC CONDUIT (SCHEDULE 40 OR SCHEDULE 80 PVC)
DRY LOCATIONS	RIGID STEEL CONDUIT AND ELECTRICAL METALLIC TUBING
ABOVE CEILING BETWEEN LIGHT FIXTURES	FLEXIBLE METAL CONDUIT (8"-0" LENGTHS MAXIMUM)

LIGHT FIXTURE SCHEDULE						
SYM.	MANUFACTURER	CATALOG NUMBER	NO. LAMPS/TYPE	WATTS	VOLTS	REMARKS
A	HALO	E71CATNB/LT560WH6930	LED	10	120	RECESSED 6" RECESSED DOWN LIGHT WITH HALO LENS KIT
C	METALUX	24GR-LD4-42-F1-UNV-L835-CDI-U	LED	43.7	120	RECESSED 2'X4' LED GRID TROFFER WITH PRISMATIC LENS
CE	METALUX	24GR-LD4-42-F1-UNV-L835-CDI-U	LED	43.7	120	RECESSED 2'X4' LED GRID TROFFER WITH PRISMATIC LENS W/90 MIN. BATTERY PACK
D	METALUX	4WNLED-LD4-40SL-F-UNV L835-CDI-U	LED	36	120	SURFACE 1'X4' FLUORESCENT WRAPAROUND
F	KENALL LIGHTING	EPLB120HLCF-26L30K8DDC	26W LED	26	120	PENDANT HIGH BAY LED
G	CUSTOM SURFBOARD LIGHT		26W LED	26	120	SURFACE OWNER PROVIDED. COORDINATE STEM HEIGHT PRIOR TO INSTALLATION.
G1	LITHONIA LIGHTING	WSR LED 1 10A700/30K SR3 MVOLT DOBXO	LED	24	120	SURFACE FULL CUT-OFF WALL PACK
H	BRITE TECH	AMBIANCE LED 2W	2.0W FROSTED LED	2.0	120	SURFACE MOUNT STRING LIGHTS TO PERGOLA
X	LITHONIA	ECB1R LED M6	LED'S W/FIXTURE	13	120/277	SURFACE EXIT SIGN WITH BATTERY BACK UP AND REMOTE HEADS
X1	PROGRESS LIGHTING	PETPEUR30RC	LED	5.0	120/277	SURFACE
EM	PROGRESS LIGHTING	PE007-03	LED'S W/FIXTURE	5.4	120/277	SURFACE 2 LIGHT EMERGENCY FIXTURE
EEM	EATON	SEL17	LED'S W/FIXTURE	12	120/277	SURFACE EXTERIOR EMERGENCY EGRESS LIGHT
NOTES: 1. ALL LIGHT FIXTURES ARE TO BE PROVIDED BY CONTRACTOR. 2. VERIFY CEILING CONDITIONS AND COORDINATE LIGHT FIXTURE MOUNTING HARDWARE NEEDED TO SUIT CEILING CONDITIONS PRIOR TO ORDERING. 3. VERIFY MODEL NUMBERS AND DESCRIPTIONS WITH MANUFACTURER PRIOR TO PLACING ORDER. 4. VERIFY FINISH AND COLOR WITH ARCHITECT PRIOR TO PLACING ORDER. 5. REFER TO ARCHITECTURAL DRAWINGS AND DETAILS FOR EXACT LOCATIONS, MOUNTING HEIGHTS AND ADDITIONAL MOUNTING INFORMATION. 6. CATALOG NUMBER REPRESENTS MANUFACTURER LISTED FIRST. OTHER MANUFACTURERS LISTED ARE CONSIDERED EQUIVALENT FOR SUBSTITUTION. 7. DUE TO AESTHETIC OR PERFORMANCE CRITERIA, SPECIFIED MANUFACTURER SHALL BE THE ONLY MANUFACTURE ALLOWED TO BID UNLESS OTHERWISE APPROVED BY ARCHITECT. 8. COORDINATE WEIGHTS AND APPROPRIATE BLOCKING/SUPPORT FOR THE CUSTOM LIGHT FIXTURES AND PENDANTS.						

PANEL: LA		400A	MLO	120/	208	V, 3PH, 4W,+G,+ISO, GND.	FAULT AT PANEL:		8884	22,000 AIC FULLY RATED	
CCT	SERVICES	VA	OC#	WIRE	PHASE	WIRE	OC#	VA	SERVICES	CCT	
1	BLOCK ICE MACHINE (1)	720	201	2#12_#12G,3/4"C.	A	3#12_#12G,3/4"C.	20/3	1801	WALK-IN FREEZER COND. (57A)	2	
3	BLOCK ICE PROD. COND. (1A)	4803	50/3	3#6_#10G,1"C.	B	---	---	1801	---	4	
5	---	4803	HACR	---	C	---	---	1801	---	6	
7	---	4803	---	---	A	---	---	20/1	SPARE	8	
9	BLOCK ICE MACHINE (1)	720	20/1	2#12_#12G_#12G,3/4"C.	B	---	20/1	SPARE	---	10	
11	SPARE	---	20/1	---	C	3#6_#10G,1"C.	50/3	5040	RTU-1	12	
13	SPARE	---	20/1	---	A	---	HACR	5040	---	14	
15	SPARE	---	20/1	---	B	---	---	5040	---	16	
17	SPARE	---	20/1	---	C	2#12_#12G,3/4"C.	---	1200	WALK-IN FREEZER EVAP. (57)	18	
19	SPARE	---	20/1	---	A	---	-	---	SPACE	20	
21	SPARE	---	20/1	---	B	---	-	---	SPACE	22	
23	SPACE	---	---	---	C	---	-	---	SPACE	24	
25	SPACE	---	---	---	A	---	-	---	SPACE	26	
27	SPACE	---	---	---	B	---	-	---	SPACE	28	
29	SPACE	---	---	---	C	---	-	---	SPACE	30	
31	SPACE	---	---	---	A	---	-	---	SPACE	32	
33	SPACE	---	---	---	B	---	-	---	SPACE	34	
35	SPACE	---	---	---	C	---	-	---	SPACE	36	
37	PANEL LB	17499	200/3	4#30,1#6G,2"C	A	---	---	---	SPACE	38	
39	---	17534	-	---	B	---	---	---	SPACE	40	
41	---	16147	-	---	C	---	---	---	SPACE	42	

NOTES:		LOAD SUMMARY		CONN	NEC	DEM	LOAD BALANCE PER PHASE	
1	NEMA 1 ENCLOSURE	1-LIGHTING	13324	1.25	16655		PHASE A	
2	PROVIDE BOLT ON BREAKERS	2-RECEP TACLES	6280	NEC	6280		PHASE B	
3	PROVIDE ISOLATED GROUND BUS BAR	3-KITCHEN	47165	0.65	30657		PHASE C	
4	RECESS MOUNT	4-HVAC	20523	1	20523		LOWEST PHASE PLUS 10%	
		5-NON-CONT	980	1	980	29991	+ 10%	
		LARGEST MOTOR	0	0.25	0		PHASES ARE BALANCED	
		TOTAL VA	88272		75095.25			
		TOTAL AMPS	245.0		208.4			

PANEL: LB			225A	MLO	120/	208	V, 3PH, 4W,+GRND.	FAULT AT PANEL:			8635	22,000 AIC SERIES RATED							
CCT	SERVICES	VA	OC#	WIRE	PHASE	WIRE	OC#	VA	SERVICES	CCT									
1	INTERIOR LIGHTING	635	201	2#12.#12G,3/4"C.	A	2#12.#12G,3/4"C.	201/GF	200	BLOCK ICE SHAVER (2)	2									
3	INTERIOR TIME CLOCK/DOOR BUZZER	180	201	2#12.#12G,3/4"C.	B	2#12.#12G,3/4"C.	201/GF	200	BLOCK ICE SHAVER (2)	4									
5	INTERIOR LIGHTING	815	201	2#12.#12G,3/4"C.	C	2#12.#12G,3/4"C.	-	1200	BUILDING LOGO SIGN (43)	6									
7	TELEPHONE BOARD	500	201	2#12.#12G,3/4"C.	A	2#12.#12G,3/4"C.	201/GF	800	FREEZER MONITOR RECEPTACLE	8									
9	STRING LIGHTS/SURF BOARD LITG	720	201	2#12.#12G,1/2G,3/4"C.	B	2#12.#12G,3/4"C.	201	300	FLY FAN (66)	10									
11	FACP	600	201	2#12.#12G,3/4"C.	C	2#12.#12G,3/4"C.	201/GF	200	BLOCK ICE SHAVER (2)	12									
13	EXTERIOR LIGHT	24	201	2#12.#12G,3/4"C.	A	2#12.#12G,3/4"C.	201/GF	800	FREEZER MONITOR RECEPTACLE	14									
15	OPEN SIGN (47)	1200	201	2#12.#12G,3/4"C.	B	2#12.#12G,3/4"C.	201/GF	1800	ICE CREAM FREEZER (17)	16									
17	BLOCK ICE SHAVER (2)	200	201	2#12.#12G,3/4"C.	C	2#12.#12G,3/4"C.	201	1000	USB RECEPTACLES	18									
19	ICE MACHINE (8)	800	201	2#12.#12G,3/4"C.	A	2#12.#12G,3/4"C.	201	900	SHOW WINDOW RECEPTACLES	20									
21	LEMONADE STA TION (75)	984	201	2#12.#12G,3/4"C.	B	2#12.#12G,3/4"C.	201	180	CONVENIENCE RECEPTACLE	22									
23	SIMPLE SYRUP MIXER (6)	792	201/GF	2#12.#12G,3/4"C.	C	2#12.#12G,3/4"C.	201	1200	BUILDING LOGO SIGN (43)	24									
25	BAG-IN-BOX (60)	500	201/GF	2#12.#12G,3/4"C.	A	2#12.#12G,3/4"C.	201	800	MENU BOARD	26									
27	WASHER/DRYER (54)	1500	201	2#12.#12G,3/4"C.	B	2#12.#12G,3/4"C.	201	500	HEADSET INTERCOM SYSTEM (65)	28									
29	DRYER (54)	2200	30/2	2#10.#10G,3/4"C.	C	2#12.#12G,3/4"C.	201	200	WATER HEATER	30									
31	-	-	2200	-	-	-	201	200	SPARE	32									
33	INTERIOR LIGHTING	90	201	2#12.#12G,3/4"C.	B	2#12.#12G,1/2G,3/4"C.	201/GF	480	POS SYSTEM (26)	34									
35	TELEVISION	600	201	2#12.#12G,3/4"C.	C	2#12.#12G,3/4"C.	201	360	RESTROOM RECEPTACLES	36									
37	BUILDING LOGO SIGN (43)	1200	201	2#12.#12G,3/4"C.	A	2#12.#12G,1/2G,3/4"C.	201	480	POS SYSTEM (26)	38									
39	TELEVISION	600	201	2#12.#12G,3/4"C.	B	2#10.#10G,3/4"C.	25/1/GF	2400	COMMERCIAL BAR BLENDER (14)	40									
41	TROPICAL DRINK STATION (4)	60	201/GF	2#12.#12G,3/4"C.	C	2#10.#10G,3/4"C.	25/1/GF	2400	COMMERCIAL BAR BLENDER (14)	42									
43	SOUND/SURVEILLANCE SYS. (31)	500	201/GF	2#12.#12G,3/4"C.	A	2#12.#12G,3/4"C.	201/GF	700	CHEST FREEZER (19)	44									
45	COOP/TOP RECEPTACLES	360	201	2#12.#12G,3/4"C.	A	-	201	SPARE	46										
47	SPARE	-	201	-	C	-	201	SPARE	48										
49	BEVERAGE DISPENSER (25)	420	201/GF	2#12.#12G,3/4"C.	A	2#12.#12G,3/4"C.	201	1200	DT/MENU BOARD	50									
51	DT/MENU BOARD	1200	201	2#12.#12G,3/4"C.	B	-	201	SPARE	52										
53	POS SYSTEM (26)	480	201/GF	2#12.#12G,3/4"C.	C	-	201	SPARE	54										
55	SPACE	-	-	-	A	-	-	-	SPACE	56									
57	SPACE	-	-	-	B	-	-	-	SPACE	58									
59	SPACE	-	-	-	C	-	-	-	SPACE	60									
61	SPACE	-	-	-	A	-	-	-	SPACE	62									
63	SPACE	-	-	-	B	-	-	-	SPACE	64									
65	SPACE	-	-	-	C	-	-	-	SPACE	66									
67	SPACE	-	-	-	A	-	-	-	SPACE	68									
69	SPACE	-	-	-	B	-	-	-	SPACE	70									
71	SPACE	-	-	-	C	-	-	-	SPACE	72									
73	SPACE	-	-	-	A	-	-	-	SPACE	74									
75	SPACE	-	-	-	B	-	-	-	SPACE	76									
77	SPACE	-	-	-	C	-	-	-	SPACE	78									
79	SPACE	-	-	-	A	-	-	-	SPACE	80									
81	SPACE	-	-	-	B	-	-	-	SPACE	82									
83	SPACE	-	-	-	C	-	-	-	SPACE	84									
NOTES:																			
1 NEMA 1 ENCLOSURE					LOAD SUMMARY					CONN	13324	1.25	16655	PHASE A	17499				
2 PROVIDE BOLT ON BREAKERS					2-RECEPTACLES					6280					NEC	6280	PHASE B	17534	
3 RECESSED PANEL					3-KITCHEN					30116					0.65	19575.4	PHASE C	16147	
					4-HVAC					0					1		LOWEST PHASE PLUS 10%		
					5-NON-CONT					980					1	980	16147	+ 10%	17761.7
					LARGEST MOTOR					0					0.25	0	PHASES ARE BALANCED		
					TOTAL VA					50700						43490			
					TOTAL AMPS					140.7						120.7			

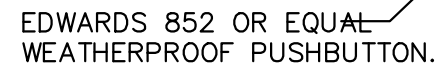
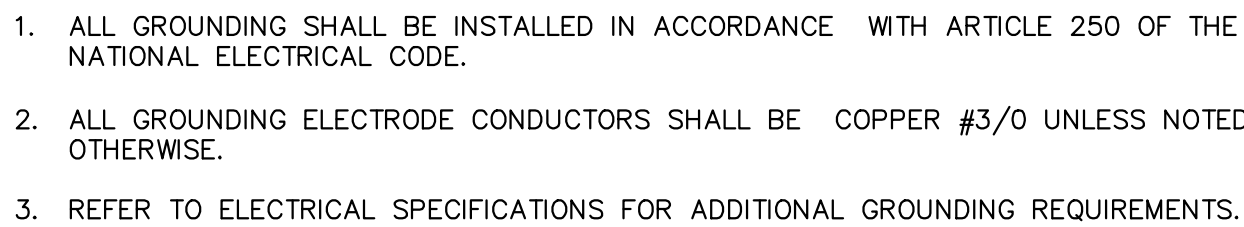

- 1) 1" CONDUIT WITH 4 EACH, 24 GAUGE COPPER, SOLID CONDUCTOR, TWISTED PAIR, CATEGORY 5 CABLE FOR POINT OF SALE COMMUNICATION CABLES, AS REQUIRED. INSTALLED BY CONTRACTOR AND FINAL CONNECTION TO PDS COMPANY.
- 2) PROVIDE 2FT. OF EXCESS CABLE AT BOTH ENDS OF RUN.
- 3) ROUTE WIRING/CONDUIT ABOVE CEILING.
- 4) 4/5 BOX WITH SINGLE GANG PLATE WITH (2) DATA PORTS.
- 5) DUPLEX ISOLATED GROUND RECEPTACLE, LEVITON #5262-IG (TYPICAL)
- 6) TERMINATE IN MANAGER'S OFFICE DATA COMMUNICATION AREA WITH 110 TYPICAL PATCH BLOCKS. THESE BLOCKS MUST INCLUDE 48 PORT RJ-45 MODULAR PATCH PANELS.



1

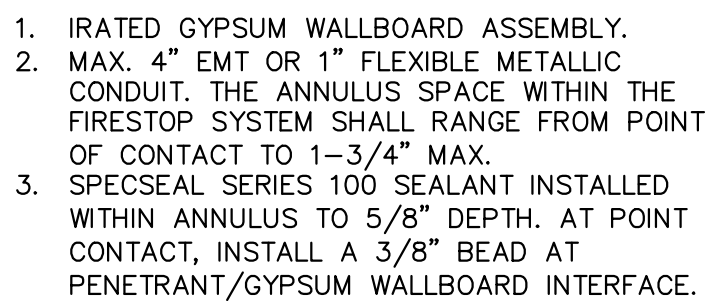
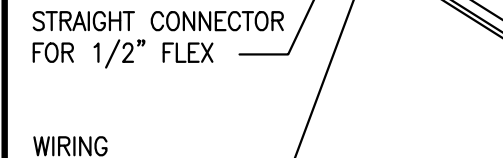

TYPICAL 1-HOUR PENETRATION

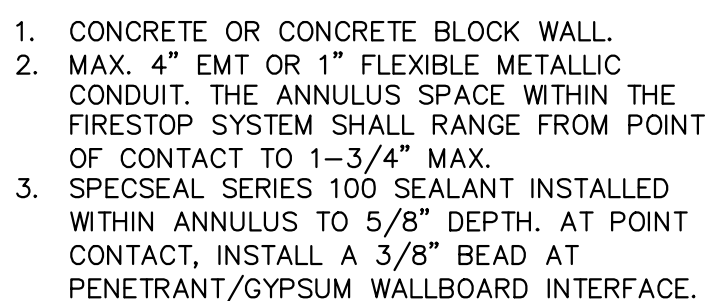

TYPICAL 2-HOUR PENETRATION



1. ALL WIRING BY ELECTRICAL CONTRACTOR.

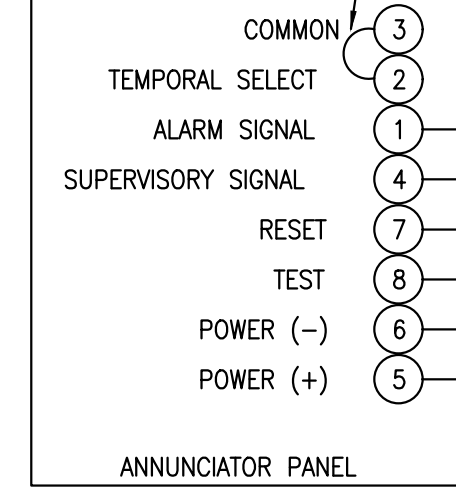

4

SCALE: NONE

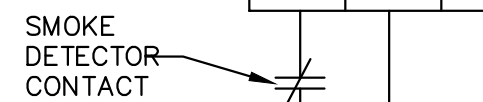

9

SCALE: NONE

NOT TO SCALE

SCALE: NONE

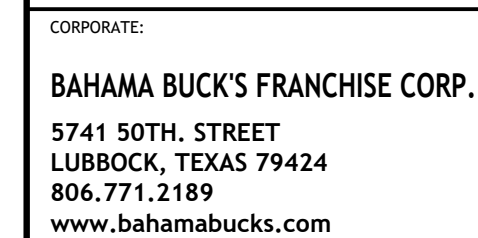

09-17-21

SHOPS AT THE HIGHLAND

538 BELT LINE RD.

CLIENT: OUR SNO CRUE IS DECKED OUT, LLC
1701 W. MAIN
LANCASTER, TX 75146

[illegible]

SHEET TITLE

ELECTRICAL DETAILS

SHEET NUMBER:

E3.1

PROJECT NUMBER:

BBS21009